

1

H1

H1

Service Entry

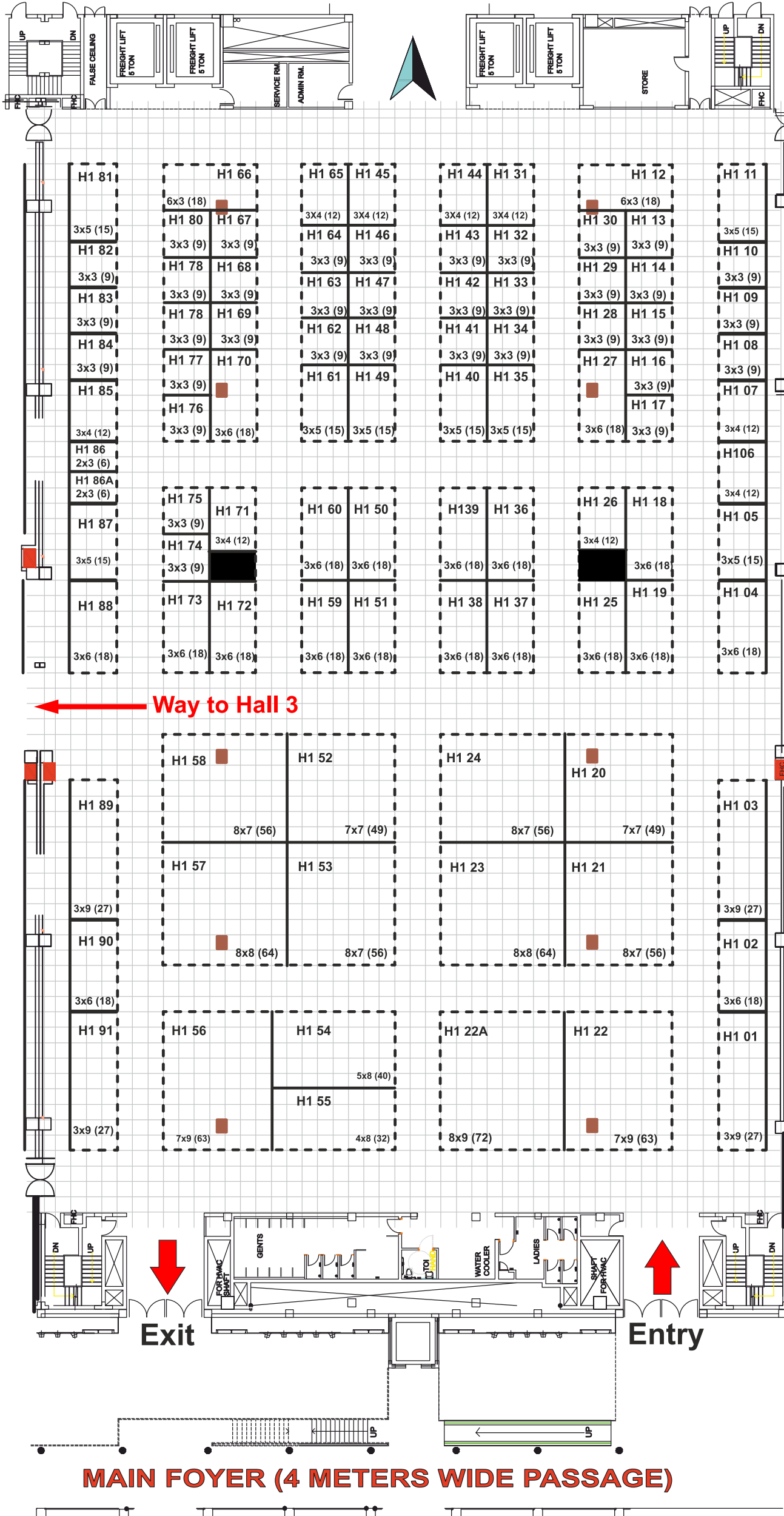

28 - 30 AUGUST
NEW DELHI 2024

IEML Knowledge Park-II,
Greater Noida Expressway, Delhi-NCR, INDIA

Ground Floor Hall No 1

Supported by:



Organized by:



LEGEND

- ELECTRICAL PANEL
- STEEL COLUMN (85cm x 65cm)
- F.H.C.
- Pillar (85cm x 65cm)

August
28 - 30, 2024
India Expo
Centre & Mart
Greater Noida,
UP, India

- NOTES:
- 1M X 1M GRID IS MARKED ON THE ENTIRE LAYOUT PLAN OF THE HALLS.
 - BEFORE TAKING UP ACTUAL CONSTRUCTION OF STANDS AT SITE, THE CONTRACTOR MUST CHECK AND CO-RELATE WITH THE DESIGN PLAN.
 - ANY ADJUSTMENTS REQUIRED MUST BE BROUGHT TO THE NOTICE OF M/S SPACE FRAMES.
 - IT MAY BE ENSURED THAT NO CONSTRUCTION IS TAKEN UP IN FRONT OF EMERGENCY EXITS, ENTRANCE GATES AND CONVENIENT ACCESS PROVIDED TO FIRE, ELECTRICIANS ETC.